

High Voltage Series -AC220V

2835 Top LED -[60 LEDs/M] (8W/M)



CRI Available
80/90/98



- Assembled by 2835 Top LEDs
- 220V AC power input, easy for direct plug-in/out without additional power supply
- Soft PVC housing with thick firm, good corrosion resistance and electrical insulation
- Self-encapsulated design offer five optional white light from 2300-6500K
- CRI 80+ , CRI 90+ and CRI 98+ are available

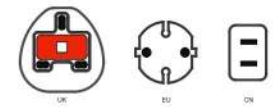

Data	
Voltage	220V AC
Power	8W/m
Current	0.037A/m
Max. LM. Flux	650LM/m
Dimensions	50000x14.3x7.5mm (1968.5"x0.44"x0.3")
Unit Length	1000mm/ 60LEDs (39.37"/ 60LEDs)
LED Qty.	60LEDs/m, 16.67mm (0.66") LED pitch
Waterproof IP	65

Ra	CCT.	Lm/M	
>80	5700-6500K	650	HVFLST2S3C-50-EU/CN
	3700-4250K	650	HVFLST2N3C-50-EU/CN
	2900-3200K	650	HVFLST2W3C-50-EU/CN
	2600-2900K		
	2300-2600K		

Structural drawing

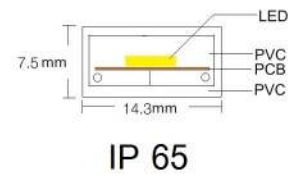

Accessory

Full set accessory

1. Transformer
2. End cap
3. Quick connector
4. Plastic clip



Cutting Unit

- 50M Roll
- ✂ CUT Every 1000mm

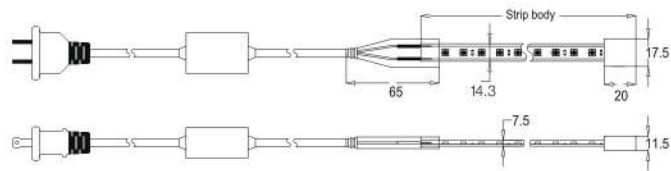
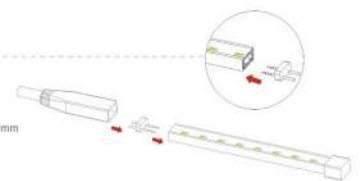

Photometric Diagrams

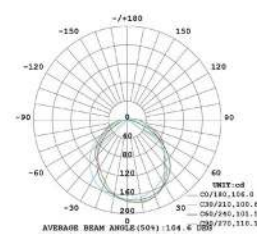

Illuminance Distribution

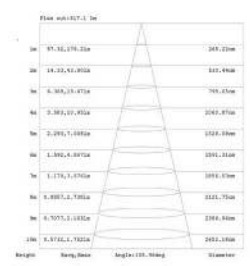

Content
Waterproof
Strip Portfolio
Constant-Current
High Efficiency
Effic-Plus
2835
2016
2110
5050
3528
Side-Front
3014
Multi-Color
Functional
Linear Light Source
AC
Neon Flex
Accessories
Packs
Linear Lighting